

## MÜLLER MS-U 80/100 G

### Spannvorrichtung / clamping device

**TA 1741** US 1/4

PN: 23083

Dat.: 20.03.2025

Name: Wiesemann

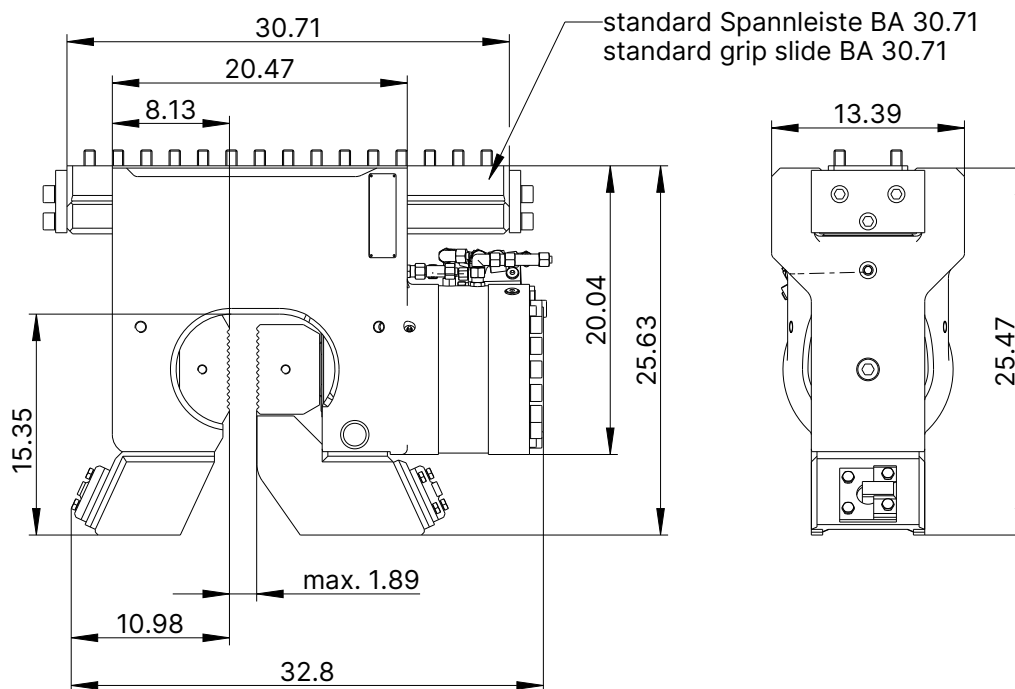
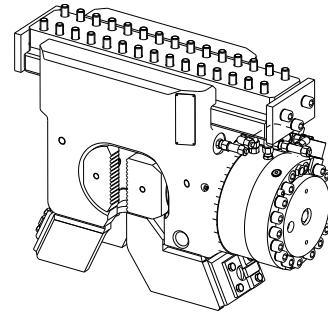
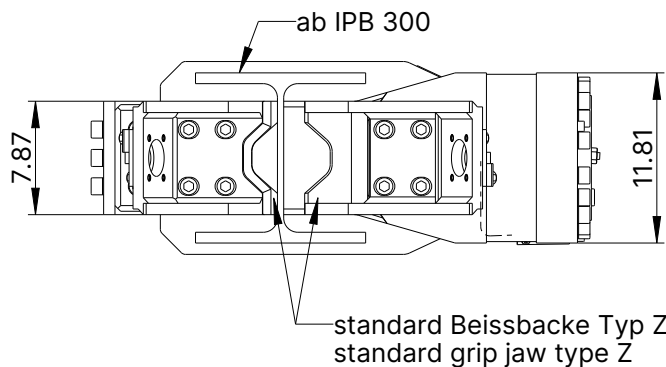

#### Technische Daten

Spannkraft, max.

Spanndruck, max.

Spannkraft (4061 psi)

Gewicht

#### Technical data

clamping power, max.

clamping pressure, max.

clamping power (4061 psi)

weight

[US ton] 112.4

[psi] 5076

[US ton] 89.9

[lbs] 1477

Artikel-Nr. /ID-no. 50094015

## MÜLLER MS-U 80/100 G

### Spannvorrichtung / clamping device

**TA 1741** US 2/4

PN: 23083  
Dat.: 20.03.2025  
Name: Wiesemann

### Kompatible Abweiser / compatible deflectors

#### *Ein Knebel / one toggle:*

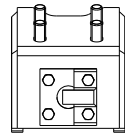

50085476\*

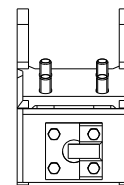
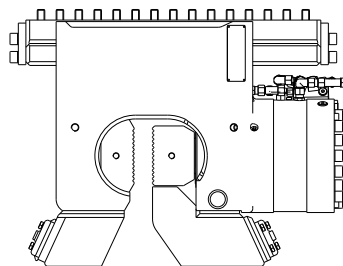

50085477

#### *Zwei Knebel / two toggles:*

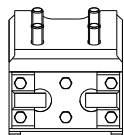

50088423\*

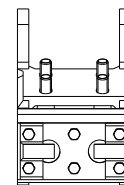
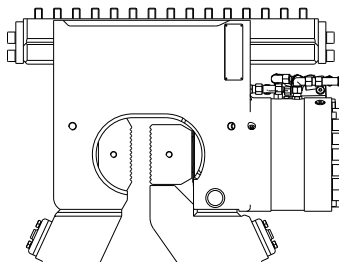

50088415

#### *Eine Kette / one chain:*

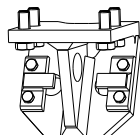

50083092

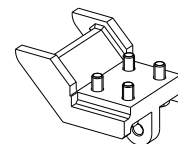
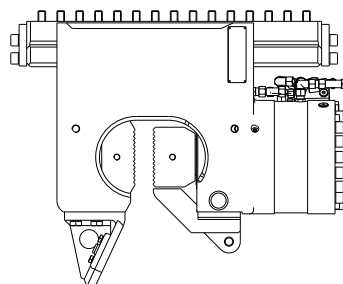

50089108

\* Mit allen Spannvorrichtung ab S/N 9081-0022 kompatibel.  
Suitable for all clamping devices from S/N 9081-0022 on.

**MÜLLER MS-U 80/100 G**
**Spannvorrichtung / clamping device**
**TA 1741** US 3/4

 PN: 23083  
 Dat.: 20.03.2025  
 Name: Wiesemann

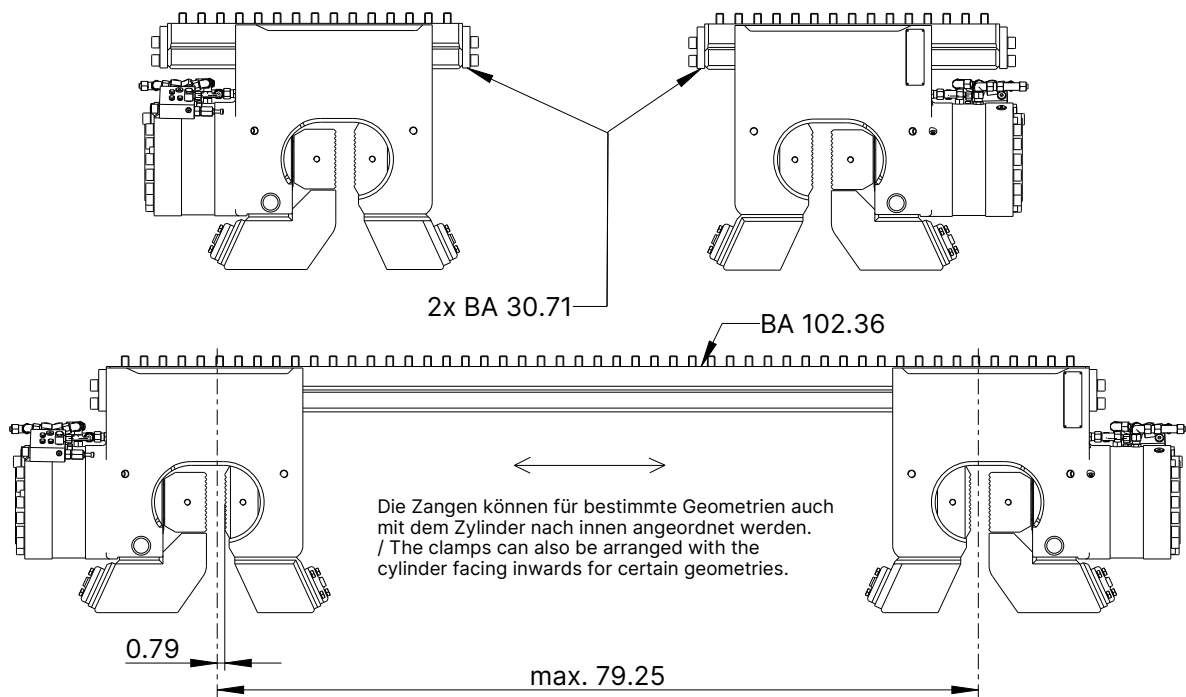
**Kompatible Spannleisten / compatible grip slides**

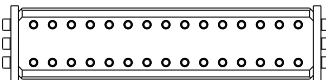
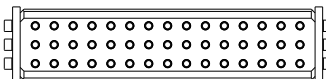
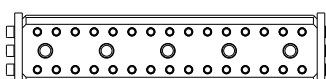
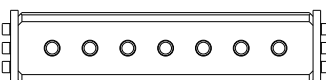
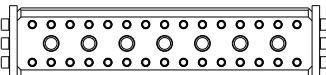
Artikel-Nr.* part numb.	Bohrbild drilling pattern	Länge length	max. Rohr- $\varnothing$ max. pipe- $\varnothing$	Überblick Bohrbilder overview drilling pattern
50078445	BA	30.71	-	BA 
50078446	BA	34.65	-	
50083736	BA	46.46	23.35**	BB 
50083300	BA	69.29	46.18	
50078449	BA	88.58	65.47	BC 
50078450	BA	102.36	79.25	
50077674	BB	30.71	-	BD 
50083293	BC	30.71	-	
50083285	BC	34.65	-	BF 
50083297	BC	44.09	20.98**	
50083301	BC	45.67	22.56**	
50083296	BD	30.71	-	
50083298	BD	47.24	24.13	
50083294	BF	30.71	-	

\* Am 01.01.24 verfügbare Geometrien, weitere möglich auf Anfrage. / Geometries available on 01.01.24, others possible on demand.

\*\* Doppelzange nur mit Abweiser 50083092 möglich. / Double clamps only possible with baffle 50083092.

## MÜLLER MS-U 80/100 G

### Spannvorrichtung / clamping device

**TA 1741** US 4/4

PN: 23083  
Dat.: 20.03.2025  
Name: Wiesemann

### Kompatible Beissbacken / compatible grip jaws

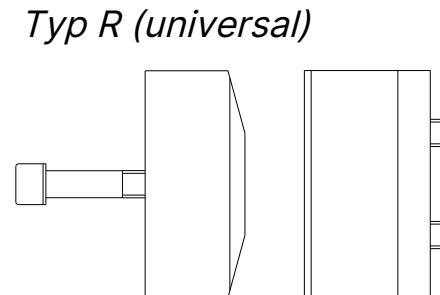
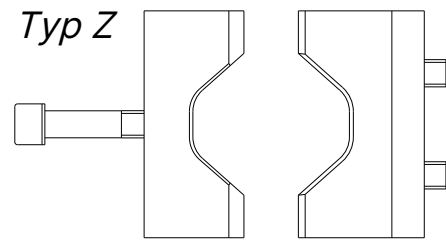
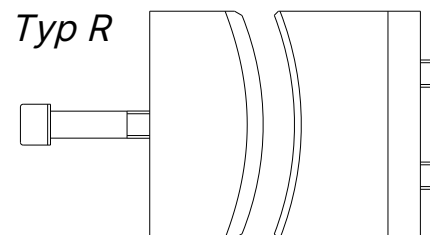
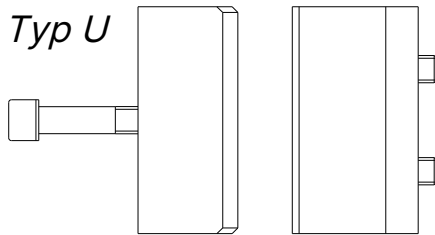

<i>Artikel-Nr.</i> <i>part number</i>	<i>Montageseite</i> <i>side of installation</i>	<i>Anwendungstyp</i> <i>application type</i>
--	--	---

50094 024	fest / solid	Typ U
50094 032	lose / loose	Typ U
50094 025	fest / solid	Typ Z
50094 033	lose / loose	Typ Z
50094 020	fest / solid	Typ R*
50094 030	lose / loose	Typ R*

{ 21.26x0.47  
 23.62x0.55  
 27.56x0.59  
 31.50x0.59  
 47.24x0.59  
 59.06x0.79  
 universal

\* Auswahl des spez. Durchmessers für Beissbacken-Typ R innerhalb der beiden Stücklisten (fest / lose). / Selection of special diameters for grip jaw type R within the two parts lists (solid / loose).